

KELVIN	CRI	REAL OUTPUT	ENERGY CLASS
2700	90	~ 180	F
3000	90	~ 180	F
4000	80	~ 230	E

2006/95/CE -- 2002/95/CE -- 1907/2006/CE -- 2010/30/UE -- EN 60598-1 -- EN 60598-2-1  
 -- EN 62471 -- EN 62031

W 2,1
IP 66
850°C GLOW WIRE TEST
CE
CABLE 1m.
700mA
0,12
Diode symbol
III

## EsyR 2.1 W

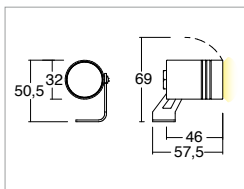

Code: **3170**

SHAPE	FINISH	COLOUR	OPTICALS
Round	Antracite ■ RAL 7016 White □ RAL 9010 Grey ■ RAL 7042 Black ■ RAL 9005 Cor-ten ■ SX350F MA.SA.	4000 K 3000 K 2700 K Red Green Blue	20° 30° 50° 120°

### ACCESSORIES

330010000	(Vin 220/240 Vac) 700 mA - 7.7 W - IP20
330009700	(Vin 220/240 Vac) 700 mA - 10 W - IP20
330009500	(Vin 220/240 Vac) 700 mA - 14 W - IP67
330009900	(Vin 220/240 Vac) 700 mA - 30 W (min 14 W) - IP67
330007800	(Vin 220/240 Vac) 700 mA - 20 W (min 7 W)
330007200	(Vin 220/240 Vac) 700 mA - 28 W (min 2 W) - Dimmer Push, 0-10, 1-10, DALI
307500019	Steel picket
307500010	Neoprene cable 2x0.5
307500020	IP68 connector
307500044	NOW System with 24vdc - 700mA converter
307500071	Satin glass option
Accessory	Asymmetrical telescope

## Description

IP66 adjustable spotlights for outdoor use, wattage 2.1 W. Installation with steel bracket. Round shape, anodised aluminium body. Finish obtained by powder-coating. Available in colour temperatures 2700 K - CRI 90 / 3000 K - CRI 90 / 4000 K - CRI 80, MacAdam Step 2. Optical lenses 20°/ 30°/ 50°/ 120° light emission. Supplied with 1 m of 2x0.5 mm section neoprene cable. Durability L80 B20 at 100.000h Ta (ambient temperature) 25° C. Version with ballast to be ordered separately.